



# EuroLED<sup>®</sup> TOUCH

**Breakthrough dual colour LED lamps with touch sensitive switching. Power saving and ultra durable.**

*Building on the durability and power saving benefits of EuroLED<sup>®</sup> single LED lamps, EuroLED<sup>®</sup>Touch also provides red light to help maintain night vision. The new lamps are controlled by the latest in completely sealed touch sensitive switching technology that provides ON/OFF and dimming functions.*

Lighting control is beautifully simple with **EuroLED<sup>®</sup>Touch** lamps. Touch the red pad for red light, the white pad for white light. Hold your finger on the pad for more than two seconds and the lamp will cycle through four dimming levels. Release your finger at the light level required.

**EuroLED<sup>®</sup>Touch** lamps can also be remotely operated with any standard ON/OFF/ON momentary switch. Light levels are 'remembered' by the lamps circuitry, even when a vehicle's batteries are turned off. The lamp will always turn on with the colour and intensity previously set, regardless of power interruption.

Advanced Hella lens technology provides a safe, smooth and uniform light pattern, without causing glare or discomfort.

Glare diffusion without light loss is important with any

LED lamp to maintain efficiency and safety, particularly with powerful lamps such as the **EuroLED<sup>®</sup>** series. Without the protection of advanced optics, eye strain can result from periods of looking directly into high power LEDs.

The durability of **EuroLED<sup>®</sup>Touch** lamps is outstanding. Each lamp is completely waterproof, impact and shock resistant, for an ultra long service life. Multivolt circuitry provides consistent illumination across a range of input voltages from 9-33V DC, even under severe voltage fluctuations.

**EuroLED<sup>®</sup>Touch** lamps overcome the poor reliability and light output problems of traditional 'red sleeved' bulb lamps. They provide ultra reliable, power saving, dual colour lighting for all types of commercial and recreational applications.

**MARKETED BY:**

Hella-New Zealand Limited  
Sales/ Customer Services  
Telephone: (09) 577-0366 Telefax: (09) 576-8202  
Web site: [www.hella.co.nz](http://www.hella.co.nz)





# Hella Product Information



## SURFACE MOUNT INTERIOR LAMPS

### Features

- Power saving red or white LED light
- Touch sensitive switching and dimming
- Completely sealed
- Shock and vibration resistant
- Multivolt 9-33V DC
- Robust mounting system
- EMC type approved
- Can be operated remotely via a switch

### Applications

- Interior lamp
- Map lamp
- Coaches
- Truck Cabs
- Caravans

#### **EuroLED® White/Red Interior/Courtesy Touch Lamp**

Lighting control is beautifully simple with EuroLED® Touch lamps. Touch the red pad for red light, the white pad for white light. Hold your finger on the pad for more than two seconds and the lamp will cycle through four dimming levels. Release your finger on the light level required.

EuroLED® Touch lamps can also be remotely operated with any standard ON/OFF/ON momentary switch. Light levels are 'remembered' by the lamps circuitry, even when a vehicle's batteries are turned off. The lamp will always turn on with the intensity level previously set, regardless of power interruption.

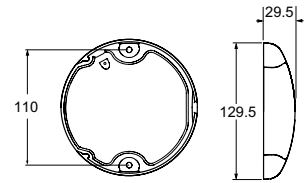

All dimensions in millimetres

2JA 959 950-011	<b>EuroLED® White/Red Interior/Courtesy Touch Lamp - Black Shroud</b>	<b>LED Multivolt</b>
2JA 959 950-021	<b>EuroLED® White/Red Interior/Courtesy Touch Lamp - White Shroud</b>	<b>LED Multivolt</b>
<b>DESCRIPTION</b>	White single LED interior lamp with Red LED night light function and touch switching and dimmer. Multiple lamps can be switched externally.	
<b>MOUNTING</b>	2 hole surface mount, mounting bushes supplied.	
<b>VOLTAGE</b>	Multivolt for optimum brightness at input voltage from 9 to 33 volts	
<b>POWER CONSUMPTION</b>	3W	
<b>PROTECTION</b>	Reverse polarity protected IP6K6 (Protection against dust and high pressure water jets) IP6K7 (Protection against temporary water immersion)	
<b>CABLE LENGTH</b>	Pre-wired with 2.5m of cable	

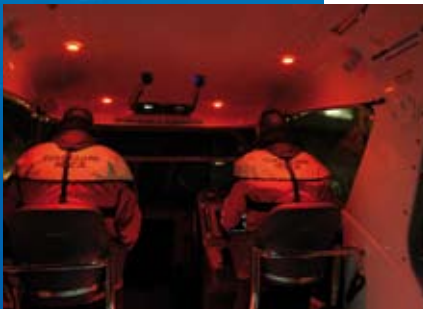

#### Red light and night vision

The human eye contains two types of receptors, rods and cones. Both have a increased sensitivity to frequency bands at different ends of the visual spectrum. Rods are largely responsible for our daytime and colour vision and have an increased sensitivity towards the red band of the visual spectrum. In contrast cones are responsible for our night vision capability and have an increased sensitivity towards the blue, shorter wavelength band of the visual spectrum. For this reason red light helps to preserve our night vision as it will not affect the sensitivity of the cones

Red mode operation



White mode operation

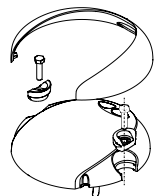

#### MARKETED BY:

Hella-New Zealand Limited  
Sales/ Customer Services  
Telephone: (09) 577-0366 Telefax: (09) 576-8202  
Web site: www.hella.co.nz

**SAFETY through Vision and Innovation**

